

Harrington



Plots
1 & 4

Harrington 3 Bedroom home with private, off road parking.

Included as standard

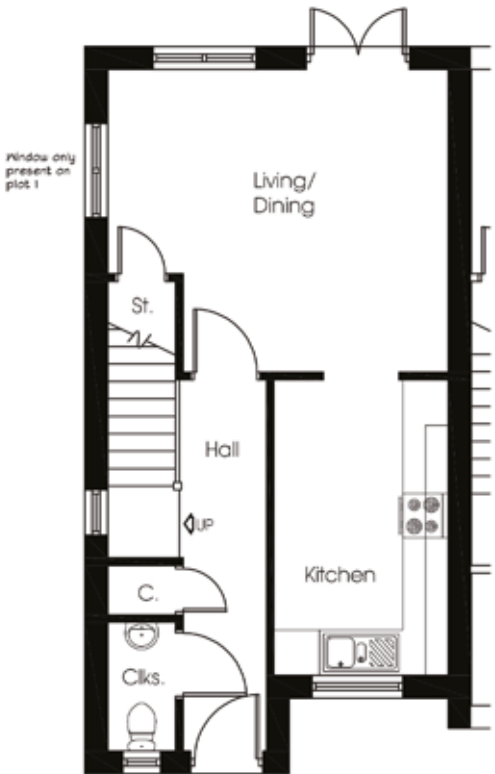
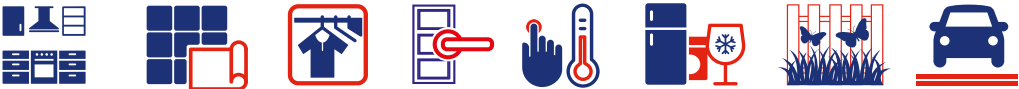

Ground Floor:
Measurements in metres

Kitchen	3.9 x 2.2
Living/dining	4.0 x 4.4
Hall	1.3 x 3.6

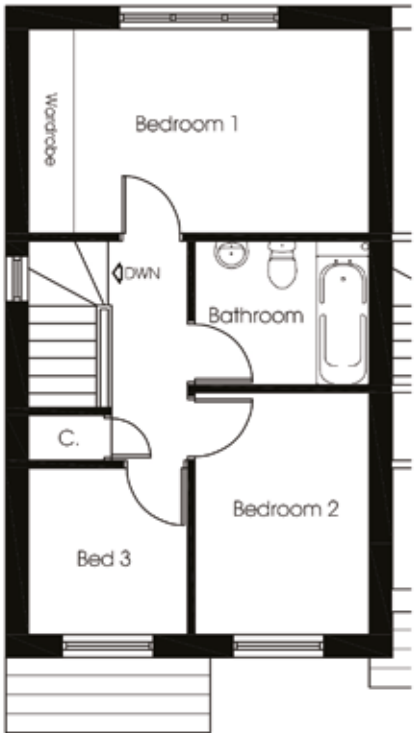

First Floor:
Measurements in metres

Bathroom	1.9 x 2.3
Bedroom 1	4.4 x 2.6
Bedroom 2	3.3 x 2.3
Bedroom 3	2.3 x 2.1